

Zip up Straight Display

SETUP INSTRUCTION

ITEMS INSIDE THE BOX



(4) Support Poles



(2) Bottom Corners



(2) Top Corners



(2) Support Feet



(2) Light Clips



(2) LED Lights
(Optional)



(1) Backdrop Graphic

01

ASSEMBLING

Connecting the poles each based on the numbers mentioned on them.

Match numbers 1 to 1,2 to 2, etc.

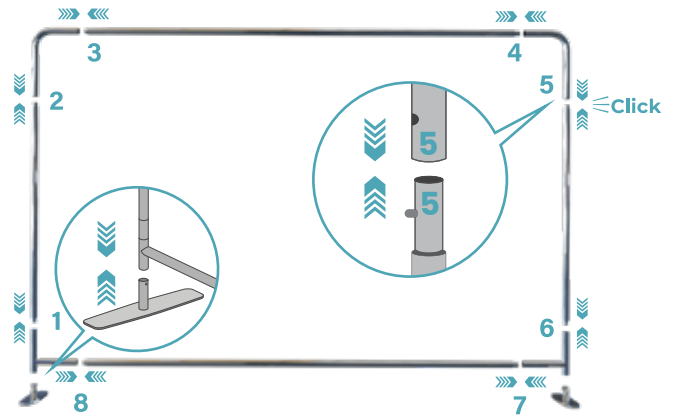

INSTALLING

02

Put the fabric print over the frame, ensuring both sides are covered completely.

It helps to have a second person to pull the other side simultaneously.

03

ATTACHING LED LIGHTS (OPTIONAL)

Attach the clips tightly on the backside of the frame and slide the lights into the clips.

To avoid stripping the light clips, do not twist the knobs too tight.



ALIGNING

04

Stand the frame straight and twist the corners until the fabric is aligned. Plug the lights and you are all set to make the best out of your display.

You can adjust the frame alignment by having a person on each side. Gently shift the top corners until the display stands completely straight.